

# User Manual

## **MAGINON**

# **Wireless Rear View Mirror** with Reversing Camera **RC-200**



# Contents

<b>Overview .....</b>	<b>3</b>
<b>Use.....</b>	<b>4</b>
<b>Scope of delivery/device parts .....</b>	<b>5</b>
<b>Preface.....</b>	<b>8</b>
<b>General .....</b>	<b>9</b>
<b>Safety.....</b>	<b>11</b>
<b>Start .....</b>	<b>15</b>
<b>Declaration of conformity .....</b>	<b>21</b>
<b>Technical specification .....</b>	<b>22</b>
<b>Storing .....</b>	<b>23</b>
<b>Cleaning.....</b>	<b>23</b>
<b>Disposal .....</b>	<b>25</b>

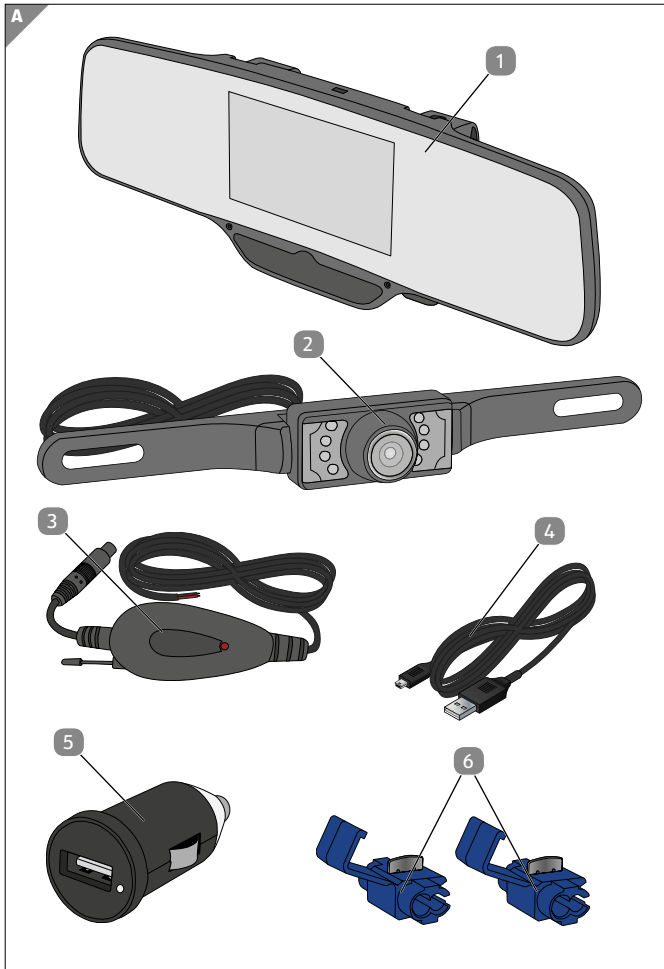

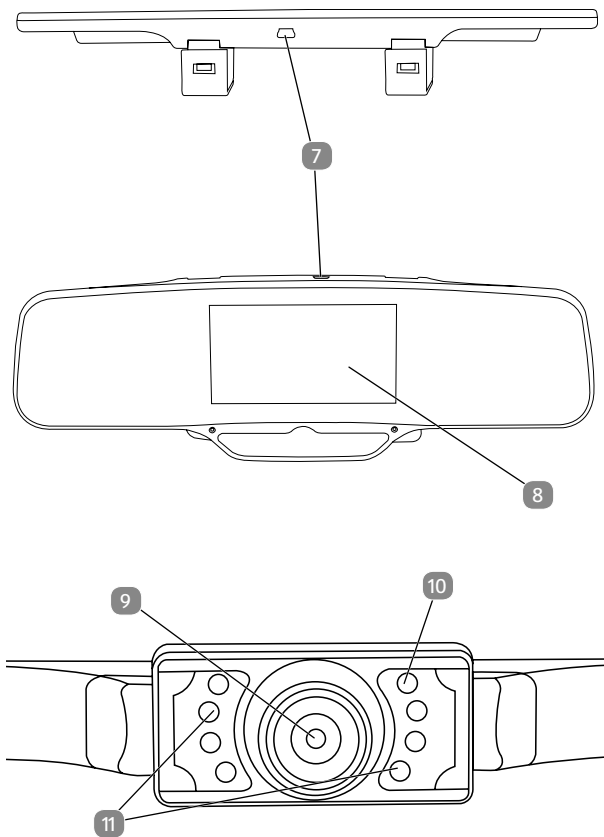

## Scope of delivery/device parts

- 1 Wireless Rear View Mirror
- 2 Reversing Camera
- 3 Transmitter box
- 4 USB cable
- 5 USB car adaptor
- 6 Cable splitter
- 7 USB connector
- 8 4.3 inch TFT colour display
- 9 Camera
- 10 Light sensor
- 11 IR LED's

---

# Content

<b>Overview .....</b>	<b>3</b>
<b>Use.....</b>	<b>4</b>
<b>Scope of delivery/device parts .....</b>	<b>5</b>
<b>Preface.....</b>	<b>8</b>
<b>General .....</b>	<b>9</b>
Read and keep instructions .....	9
<b>Safety .....</b>	<b>11</b>
Correct use .....	11
Safety information .....	11
<b>Start .....</b>	<b>15</b>
Preparing the Mirror with Reversing Camera .....	15
Contents of box.....	15
Installation of camera.....	16
Connection of camera .....	17
Installation of mirror.....	18
Power supply .....	19
Displaying the camera image .....	20
<b>Declaration of conformity.....</b>	<b>21</b>
<b>Technical specification.....</b>	<b>22</b>
<b>Storing .....</b>	<b>23</b>
<b>Cleaning.....</b>	<b>23</b>
<b>Disposal .....</b>	<b>25</b>
Disposal of packaging .....	25
Dispose of used device .....	25

## **Preface**

Dear customer,

Congratulations on purchasing a high quality MAGINON product.

You have chosen a modern Wireless Rear View Mirror with Reversing Camera with excellent technical equipment and respective accessory, which is particularly easy to operate.

The device comes with a 3 year warranty. In case of a defect in the Wireless Rear View Mirror with Reversing Camera, you require the enclosed warranty card and proof of purchase. Keep these in a safe place.

## **Imprint**

Issued by:

**supra**

Foto-Elektronik-Vertriebs-GmbH

Denisstr. 28A

67663 Kaiserslautern

Germany

# General

## Read and keep instructions



This Operating Instruction belong to this Wireless Rear View Mirror with Reversing Camera. It contains important information about the start up and handling.

For ease of understanding, the “Wireless Rear View Mirror with Reversing Camera” is just referred to as Mirror with Reversing Camera in these Operating Instructions.

Study these Operating Instructions and, in particular the Safety Information in detail prior to using the Mirror with Reversing Camera. Non observance of these Operating Instructions can lead to loss of data or damage to the Mirror with Reversing Camera.

These Operating Instructions are based on valid standards and regulations of the EU. Also observe specific guidelines and laws in other countries!

Keep the Operating Instructions for further use. When passing on the Mirror with Reversing Camera to third parties please also include these Operating Instructions.

## Explanation of symbols

The following symbols and signal words are used in these Operating Instructions, on the device or on the packaging.

 **DANGER!**

These signal words indicate a high level hazard which could cause death or serious injury if not avoided.



**⚠ WARNING!**

These signal words indicate a medium level hazard which could cause death or serious injury if not avoided.

**⚠ CAUTION!**

This signal word indicate a low level hazard which could cause slight or moderate injury if not avoided.

**NOTE!**

This signal word warns against potential material damage or provides useful additional information regards assembly or operation.



This symbol indicates useful additional information for the assembly or operation.



Declaration of conformity (see chapter “Declaration of conformity”): Products marked with this symbol meet all applicable Community regulations for the European Economic Area.

---

# Safety

## Correct use

The Mirror with Reversing Camera is solely designed to be used as a Rear View Mirror with Reversing Camera. It is only suitable for private and not commercial use.

Only use the Mirror with Reversing Camera as described in the Operating Instructions. Any other use is deemed to be incorrect and can cause material damage and loss of data.

The manufacturers or dealers do not accept any liability for damage resulting from improper or incorrect use.

## Safety information



### Electrocution hazard!

Faulty electrical installations or excessive mains voltage can cause electrocution.

- Only connect the Rear View Mirror and Reversing Camera if the mains voltage of the power point matches the voltage specified on the rating plate.
- Do not operate the Rear View Mirror and Reversing Camera in case of visible damage or if the mains cable or connector is defective.
- Damaged mains cables of the Rear View Mirror and the Reversing Camera must be replaced by the manufacturer or customer service or a similar qualified person.
- Do not open the housing but have repair carried out by an expert. Contact a specialist workshop. All liability and

warranty claims shall be void in case of repairs carried out by users, incorrect connection or improper use.

- The Rear View Mirror and Reversing Camera may not be operated with an external timer or separate remote control system.
- Never immerse the affiliated components except the Reversing Camera to water or other fluids. There is a fire and electric shock hazard.
- Keep Rear View Mirror, mains cable and Reversing Camera away from open flames and hot surfaces.
- Do not kink the mains cable and do not install it over sharp edges.
- Do not expose the integrated battery to excess heat such as sun radiation, fire, etc. Fire and explosion hazard.
- Battery Disposal: Old or discharged batteries must be properly disposed of and recycled in compliance with all applicable laws. For detailed information, contact your local solid waste authority.
- Ensure that children do not push objects into the Rear View Mirror or Reversing Camera.
- When not using or cleaning the Mirror with Reversing Camera or in case of a fault, always switch off the Mirror with Reversing Camera and disconnect the power supply.



### **Electrocution hazard!**

**Hazard or children and persons with reduced physical, sensory or mental abilities (such as partially disabled, older persons with limited physical and mental abilities) or lack of experience and know-how (such as older children).**

- This Mirror with Reversing Camera may not be used by persons with reduced physical, sensory or mental abilities or lack of experience or know-how provided they are supervised or have been instructed on how to safely use the Wireless Rear View Mirror and understand hazards resulting therefrom. Children may not play with the Mirror with Reversing Camera. The Mirror with Reversing Camera may not be cleaned or maintained by children.
- Keep children under the age of eight away from the Rear View Mirror, Reversing Camera and the mains cable.
- Do not leave the Mirror with Reversing Camera unattended during operation.
- Keep packaging foil away from children. They could get caught in it during play and could suffocate.

## **NOTE!**

### **Danger of material damage!**

Incorrect use of the Mirror with Reversing Camera can cause the Mirror with Reversing Camera to be damaged.

- When installing and assembling the Mirror with Reversing Camera ensure that a 10 cm gap is maintained on all sides in order to provide adequate ventilation. Ensure, in particular, that ventilation slots are not covered by newspaper, table clothes or curtains.
- Never place the Mirror with Reversing Camera on or near hot surfaces (e.g. stove tops, etc.).
- Ensure that the mains cable does not come into contact with hot parts.
- Never expose the Mirror with Reversing Camera to excessive temperatures (heating, etc.). Never pour liquid

into the Mirror with Reversing Camerar.

- When cleaning, never immerse the Mirror with Reversing Camera in water and do not use steam cleaner. The Mirror with Reversing Camera could otherwise be damaged.
- Do not use the Mirror with Reversing Camera if plastic or metal parts of it show cracks or tears or are deformed. Replace damaged parts only with original spare parts.
- If the Mirror with Reversing Camera has been dropped or the housing is damaged, turn it off. Otherwise there is a fire and electric shock hazard.
- The Mirror with Reversing Camera may not be taken apart, modified or repaired. There is a fire and electric shock hazard.
- Make sure that you do not drop the LCD monitor or apply pressure to the monitor screen. This could result in the glass of the monitor being damaged. If the monitor liquid gets into your eyes or onto your skin, it must be rinsed off immediately with clear water. Seek medical attention immediately.
- Damage to the electronics or accessory caused by external influences such as impacts, falls or others are not covered by the warranty and are chargeable.
- Do not drop or bump the Mirror with Reversing Camera and always treat it with care. Otherwise, it could get damaged.
- The Reversing Camera is waterproof to IP standard IP68.

---

# Start

## Preparing the Mirror with Reversing Camera

- Remove packaging material and all protective foil.

### Contents of box

 **WARNING!**

#### **Danger of suffocation!**

Keep plastic foil and bags away from babies and small children as danger of suffocation.

**NOTE!**

#### **Danger of damage!**

If the packaging is carelessly opened with a sharp knife or other pointed objects, the product can be easily damaged.

- Please open packaging carefully.
1. Check that delivery is complete (see **Fig. A**).
  2. Remove the Mirror with Reversing Camera from packaging and check whether the equipment or parts are damaged. If yes, do not use the Mirror with Reversing Camera. Contact the service address of the manufacturer listed on the Warranty Card.

## Installation of camera

The camera must be mounted to the rear end of your vehicle. The mount is designed to be fixed with the screws of your license plate. However the camera can also be mounted in a different position with two screws.

Mount the camera to a position which will ensure a clear view behind you. Furthermore please ensure a secure cable route as well.

Screw the base of the mount to the surface with the supplied screws. Bear in mind that the “UP” marked side of the camera is pointing upwards. Now install the cables to the designated position.



Professional installation is recommended.  
Install at your own risk.

## Connection of camera

To supply your camera with power it must be connected to the connecting cable of your vehicle's reversing lights. The camera is then activated every time the reverse gear is selected.

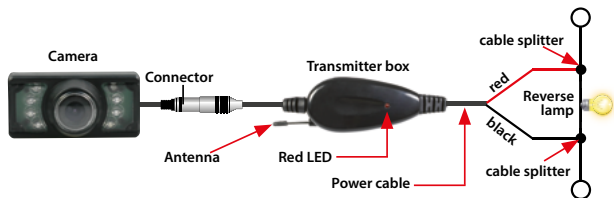

Use the included 2 pieces of cable splitter to connect the red camera cable to the positive cable of the reversing lights and the black cable to the negative cable as shown on below figure 1 - 3. The positive cable is normally colored, whilst the negative cable is generally black. However, for absolute certainty the correct cables should be determined by measuring or checking with the manufacturer.

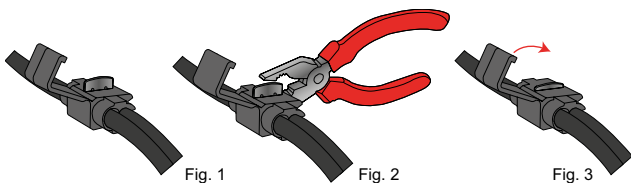

Ensure that the cables are accurately connected and insulate the connecting points to prevent bad contacts and short-circuiting! Double check brake lights to ensure the lights are still functional. If the camera turns on when braking, the camera has been installed to the wrong source.



## Installation of mirror

Attach the mirror and integrated display to the existing rear view mirror of your vehicle as follows: Position the bottom fixture on the rear of the mirror against the bottom of the rear view mirror. Slide top fixture upwards and push over the top edge of the rear view mirror. As soon as you let go of the top fixings, the fixings will clamp around the rear view mirror. Additionally secure mirror using existing rubber bands.

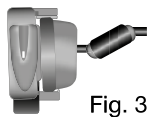
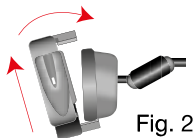
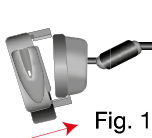

## Power supply

To supply the mirror with power connect it to the USB car adaptor using the USB cable and plug the adaptor into the cigarette lighter socket of the vehicle. Once the USB car adaptor has been plugged into the cigarette lighter socket and voltage is applied, the red LED of the adaptor lights up.



### Note!

When connecting the system to the cigarette lighter socket, care must be taken to ensure that the USB cable does not hinder the driver. Otherwise this may increase the risk of an accident.

## Displaying the camera image

As soon as the mirror is supplied with power it is ready for use. Now switch your car into reverse gear which will activate the camera as well as the display of the mirror.

The picture of the camera is inverted in order to adapt to your rear view mirror. In addition colored lines are being displayed for orientation purpose.



# Declaration of conformity



The EC Declaration of Conformity can be requested from the below address.

The manufacturer hereby declares that the CE marking was applied to the product in accordance with the basic requirements and other relevant provisions of the following European Directives:

2006/95/EC Low Voltage Directive

2004/108/EC EMC Directive

**supra**

Foto-Elektronik-Vertriebs-GmbH  
Denisstr. 28A, 67663 Kaiserslautern,  
Germany

## Technical specification

Model:	RC-200
Sensor:	1/3" CMOS colour sensor
LCD:	4.3" TFT (480 x 272 pixel) colour display
Camera frequency:	2.4 GHz
Video resolution:	480 x 272
Night vision:	yes
Spray water protected:	yes (camera) - IP protection class 68
Shockproof:	yes (camera)
Viewing angle:	170° horizontally, 90° vertically
Power supply:	USB car adaptor, 12-24V, (5V DC,1A)
Connectors:	Mini USB 2.0 for power supply



### **Note!**

We reserve the right to make technical and optical changes to the product as part of product improvements.

## Storing

When not in use please disconnect the Mirror with Reversing Camera from the power supply and store it in a clean and dry place outside of the reach of children.

## Cleaning

### **WARNING!**

#### **Burn hazard!**

The Mirror with Reversing Camera becomes hot during operation! Let it cool down completely.

### **NOTE!**

#### **Danger of short circuit!**

Any water that has entered the housing can cause a short circuit.

- Never immerse the Mirror with Reversing Camera.
- Ensure that no water enters the housing.

## **NOTE!**

### **Danger from incorrect operation!**

Incorrect use of the Mirror with Reversing Camera can cause the Mirror with Reversing Camera to be damaged.

- Do not use any aggressive cleaners, brushes with metal or nylon bristles or sharp or metallic cleaning objects, such as knives, hard spatulas and similar. These can damage the surface.
  - Never place the Mirror with Reversing Camera in dishwasher. This would destroy the device.
1. Pull out mains connector prior to cleaning.
  2. Let the Mirror with Reversing Camera cool down completely.
  3. Wipe the Mirror with Reversing Camera with a slightly damp cloth. Let the Mirror with Reversing Camera dry completely.

# Disposal

## Disposal of packaging



For disposal, separate packaging into different types. Cardboard and board must be disposed of as paper and foil must be recycled.

## Dispose of used device

(Applicable in European Union and other European countries using systems for separate collection of recyclables)



**Do not dispose of used devices in household waste!** If the Mirror with Reversing Camera can no longer be used each consumer is **legally obliged to dispose of used devices, separately from domestic waste**, e.g. at a collecting point of the municipality/district. This ensures that used equipment is recycled correctly and that negative effects on the environment are avoided. Electrical equipment is consequently marked with the adjacent symbol.



**MAGINON**



**Made in China**

DISTRIBUTED BY:

ALDI STORES  
1 SARGENTS ROAD  
MINCHINBURY NSW 2770  
[www.aldi.com.au](http://www.aldi.com.au)

**AFTER SALES SUPPORT**

46533 

 **AUS 1 800 623 432**

 **[info@supra-electronics.com](mailto:info@supra-electronics.com)**

MODEL:  
RC-200

08/2016

**3**  
**YEARS**  
**WARRANTY**

VI.1.0.au